



# Ecolid<sup>®</sup>

STEEL DOOR

 A High Quality Door Made in Sweden



In a highly automated and state-of-the-art facility, situated in the middle of the Swedish province of Västergötland, we produce more than 11,500 high-quality industrial doors every year, making us one of Europe's largest folding door manufacturers.

Thanks to our just over 45 years of experience, we can offer you an industrial door solution that not only provides a high level of functionality, but also contributes to an attractive and well-considered environment throughout your premises. Our highly automated production facilities, combined with our focus on efficiency and quality, means that we can offer competitively priced doors that will ensure low costs for our customers far into the future.

Our long experience has taught us that development and manufacturing must go hand in hand. To maintain full control, we strive to do everything in our own factory.

By listening to the needs of clients and users, we have learnt that no single product suits everyone, and that the design has great significance for the whole. The doors must be custom-built according to the opening, and they must be simple to install and maintain.

Quality pays off. That's why our products come with a 7-year warranty as standard, and have the fewest maintenance requirements on the market. It costs to maintain high quality, while the right sales price is also important. Automated production and organizational efficiency are therefore our highest priorities.

It is not only the product that constitutes the whole, all the encompassing services are often just as important. Let our Technical Support department assist you while our installation team ensures that your Prido door is installed the way you expect it to be.

Short delivery times and high delivery reliability are our defining characteristics – get in touch with us to see what we can offer you.





## Why you should buy an Ecolid steel door:

- Based on 'Ecolidporten', Sweden's bestselling folding door
- Highest-quality design and finish
- Short delivery times and high delivery reliability
- Approx. 40% higher U-value than steel frame doors
- Thermal break in the frame
- Aluminum frame with high torsional stiffness and integrated seal tracks
- Highly effective rust protection
- Quick and simple to install with the supplied frame screws and adjustment sockets fitted to the frame
- Minimal maintenance requirements
- Developed and manufactured in Sweden
- Completely made to order in a variety of designs
- Standard design available for immediate delivery
- Powerful lever handle included as standard
- Adjustable security strike plate as standard
- Manual Attack Resistance class RC2 in accordance with EN1627
- Back edge lock as standard
- Airtightness class 4 in accordance with EN12207
- CE-marked according to European standard EN14351-1
- 7-year warranty

C-frame (no integrated architrave)

Horizontal section

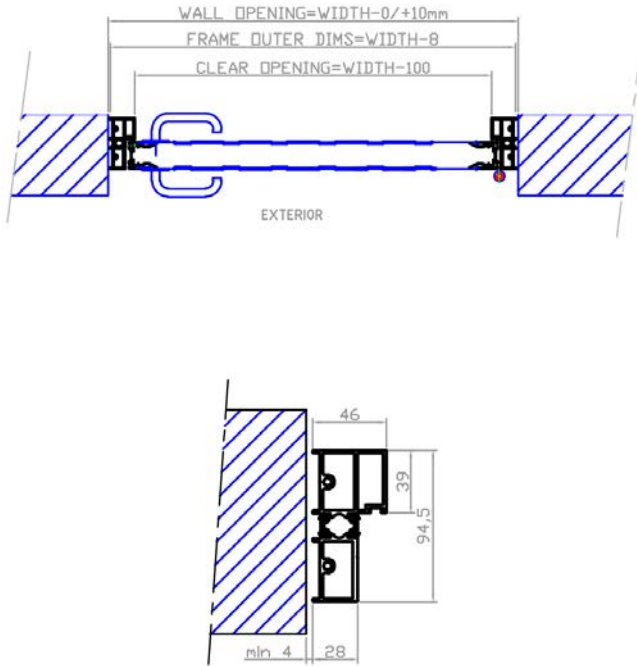

Vertical section

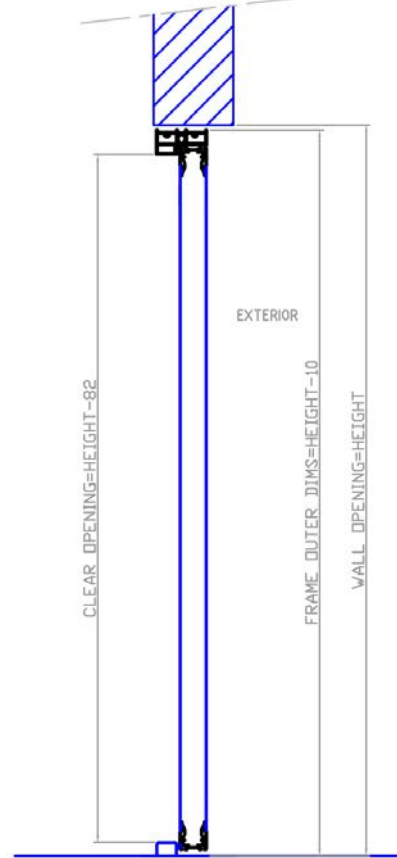

C-frame with lining strip (optional, fitted by customer)

Horizontal section

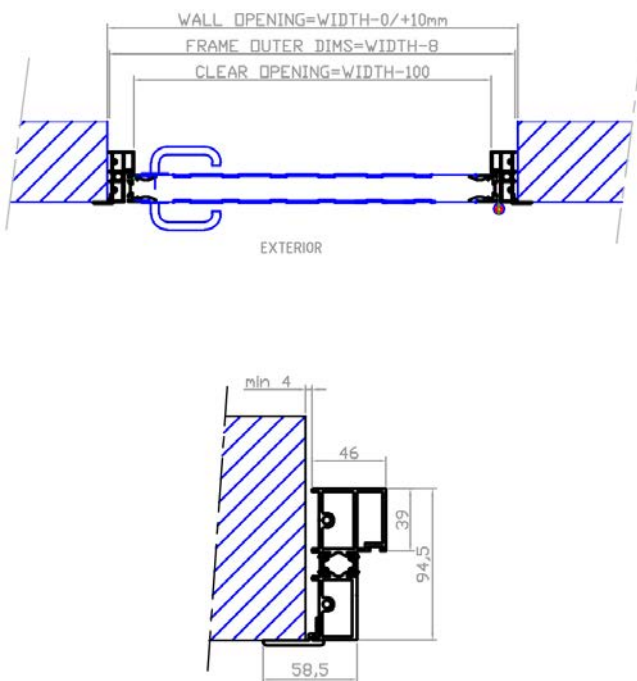

Vertical section

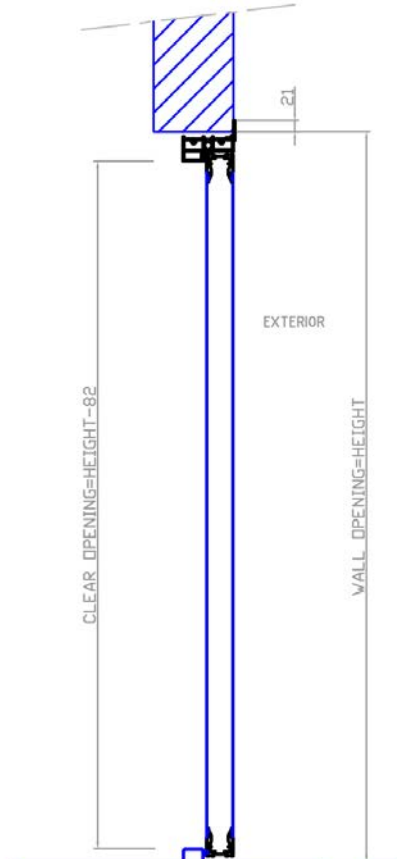



Code lock (optional)



Electric strike plate (optional)



Door closer (optional)

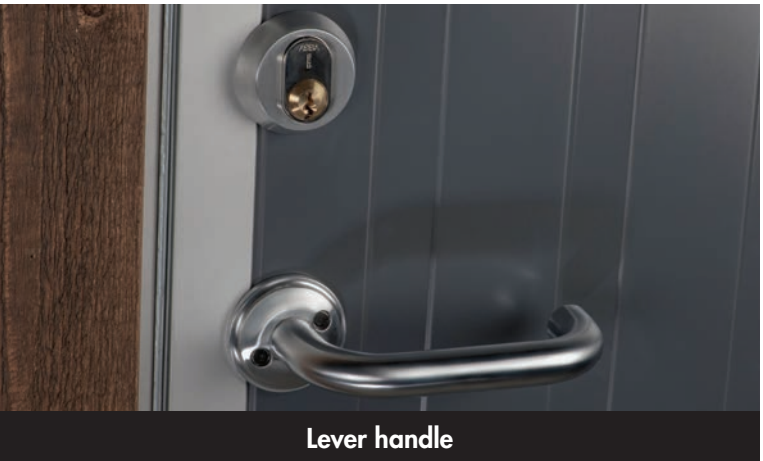

Lever handle



Hook bolt lock

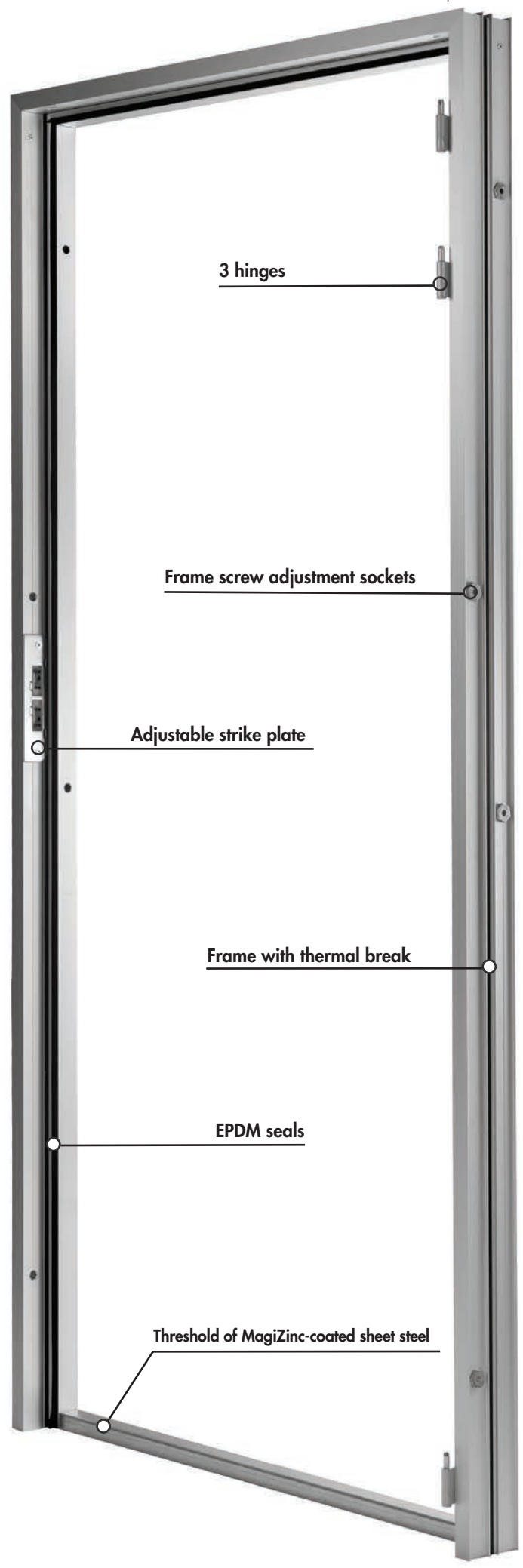

3 hinges

Frame screw adjustment sockets

Adjustable strike plate

Frame with thermal break

EPDM seals

Threshold of MagiZinc-coated sheet steel

Frame with thermal break

# Ecolid Steel Door – Technical data

## CE-marking

All doors are CE-marked pursuant to the Construction Products Regulation in accordance with applicable standard EN14351-1

## Insulation Value

U-value 1.98 W/(m<sup>2</sup>/K) calculated as per EN10077-2

## Airtightness

Class 4 in accordance with EN12207

## Closing force

Class 2 in accordance with EN12046-2

## Waterproofness

Class 3B in accordance with EN12208

## Wind load capacity

Class 3 in accordance with EN12210

## Door leaf

Process-laminated sandwich panels. 50 mm thickness.

Max. size, width x height = 1329 mm x 2500 mm. Frame of natural anodized aluminum profiles. Steel reinforcements embedded in door leaf for the hinges,

door closer and other components.

## Standard sizes (inner opening dimensions)

900 x 2100 mm  
1000 x 2100 mm  
1200 x 2100 mm

## Facing

Interior and exterior made of hot-dip galvanized sheet steel. Lacquered with 25 µm polyester paint.

## Insulation

50 mm freon-free polyurethane cellular plastic.

## Frame and seals

Natural anodized profiles with thermal break. Integrated tracks for EPDM rubber seals.

## Threshold

Strong threshold made from MagiZinc-coated sheet steel.

## Locks and fittings

Dorma 919-50 lock housing and adjustable Dorma 9009 strike plate as standard. Optional Step 40 electric strike plate with

ASSA 222 lock also available. Other locks and strike plates available at extra charge. Habo Atlanta lever handle as standard. 3 x ASSA 3220 hinges.

## Attachment

8 adjustment sleeves integrated in the aluminum frame. Self-tapping frame screws for steel and wood included.

## Window

Argon-filled D4-12 insulated-glass panes in six different standard sizes. Approx. 1070 mm standard breast height. Seven-year warranty against condensation between glass panes. Window frames made from natural anodized aluminum profiles with thermal breaks.

## Manual Attack Resistance

Class RC2 in accordance with EN1627 Back Edge Lock (the classification applies provided that the door is equipped with an ASSA D12 round cylinder)

## 7-year warranty

See separate documents for our warranty terms and conditions.

## Ecolid color chart

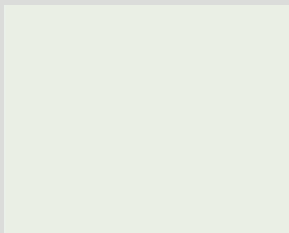

White 010  
RAL 9010

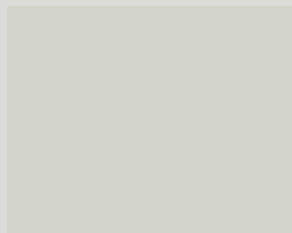

Silk gray 022  
RAL 7044



Blue 558  
RAL 5009

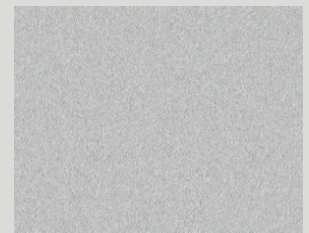

Silver 045  
RAL 9006



Forest green 874  
Closest to NCS S 6020-G30Y

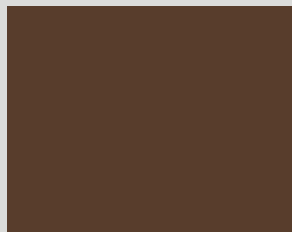

Chocolate brown 434  
RAL 8017

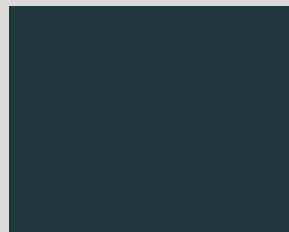

Graphite gray 036  
RAL 7024

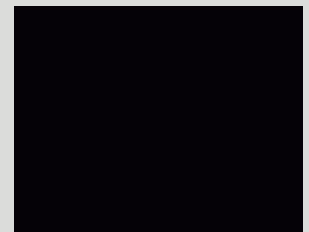

Black 015  
RAL 9005



Red 758  
RAL 3009

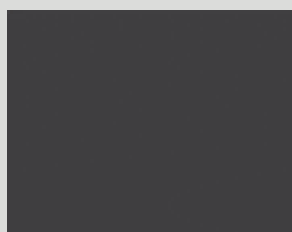

Anthracite gray 035  
RAL 7016

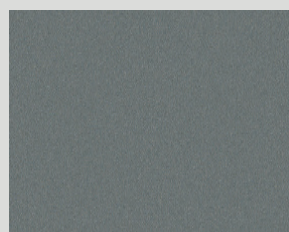

Graphite 044  
RAL 9007





## Professional Industrial Doors

Prido has over 45 years of solid experience and is one of the leading companies in the industry.

We design, develop, manufacture and market industrial door solutions for industries and other professional users in the Nordic region and Northern Europe. Our goal is to offer the most attractive and market-adapted range in the sector.

[www.prido.se](http://www.prido.se)

Prido AB | Industrigatan 3 | SE-534 92 Tråvad | Tel. no. +46 (0)512 295 90 | [www.prido.se](http://www.prido.se)

